

# Soils Map

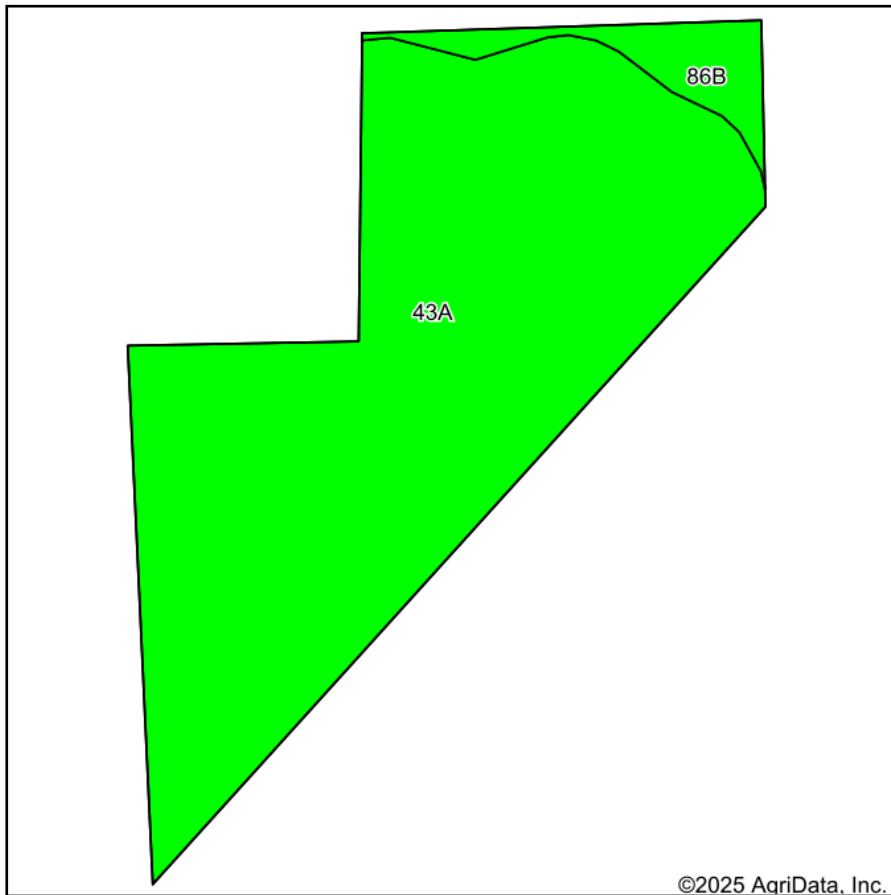

Soils data provided by USDA and NRCS.

©2025 AgriData, Inc.

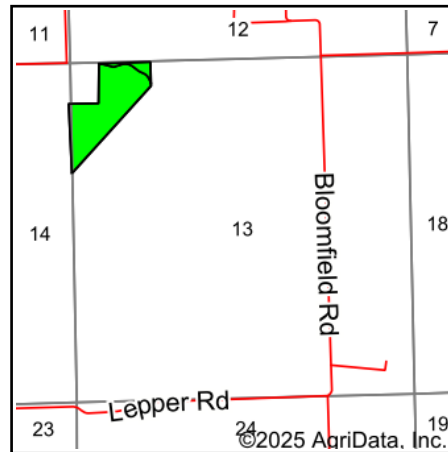

State: **Illinois**  
 County: **Morgan**  
 Location: **13-16N-9W**  
 Township: **Prentice**  
 Acres: **23.91**  
 Date: **1/6/2025**

Maps Provided By:



Area Symbol: IL137, Soil Area Version: 15

Code	Soil Description	Acres	Percent of field	Il. State Productivity Index Legend	Subsoil rooting <b>a</b>	Corn Bu/A	Soybeans Bu/A	Wheat Bu/A	Oats Bu/A <b>b</b>	Sorghum <b>c</b> Bu/A	Grass-legume <b>e</b> hay, T/A	Crop productivity index for optimum management	*n NCCPI Soybeans
43A	Ipava silt loam, 0 to 2 percent slopes	22.46	93.9%		FAV	191	62	77	100	0	5.90	142	77
**86B	Osco silt loam, 2 to 5 percent slopes	1.45	6.1%		FAV	**187	**59	**74	**100	0	**6.80	**138	78
<b>Weighted Average</b>						<b>190.8</b>	<b>61.8</b>	<b>76.8</b>	<b>100</b>	<b>*</b>	<b>6</b>	<b>141.8</b>	<b>*n 77.1</b>

**Table: Optimum Crop Productivity Ratings for Illinois Soil EFOTG are sourced from Bulletin 811 calculated Map Unit Base Yield Indices, and adjusted (Adj) for slope, erosion, flooding, and surface texture.** Publication Date: 02-08-2023

Crop yields and productivity (B811 EFOTG) are maintained at the following USDA web site: 2023 Illinois Soil Productivity and Yield Indices: <https://efotg.sc.egov.usda.gov/#/state/IL/documents/section=2&folder=52809>

\*\* Base indexes from Bulletin 811 adjusted for slope, erosion, flooding, and surface texture according to the Il. Soils EFOTG

**b** Soils in the southern region were not rated for oats and are shown with a zero "0".

**c** Soils in the northern region or in both regions were not rated for grain sorghum and are shown with a zero "0".

**e** Soils in the well drained group were not rated for grass-legume and are shown with a zero "0".

\*n: The aggregation method is "Weighted Average using all components"