

# Soils Map

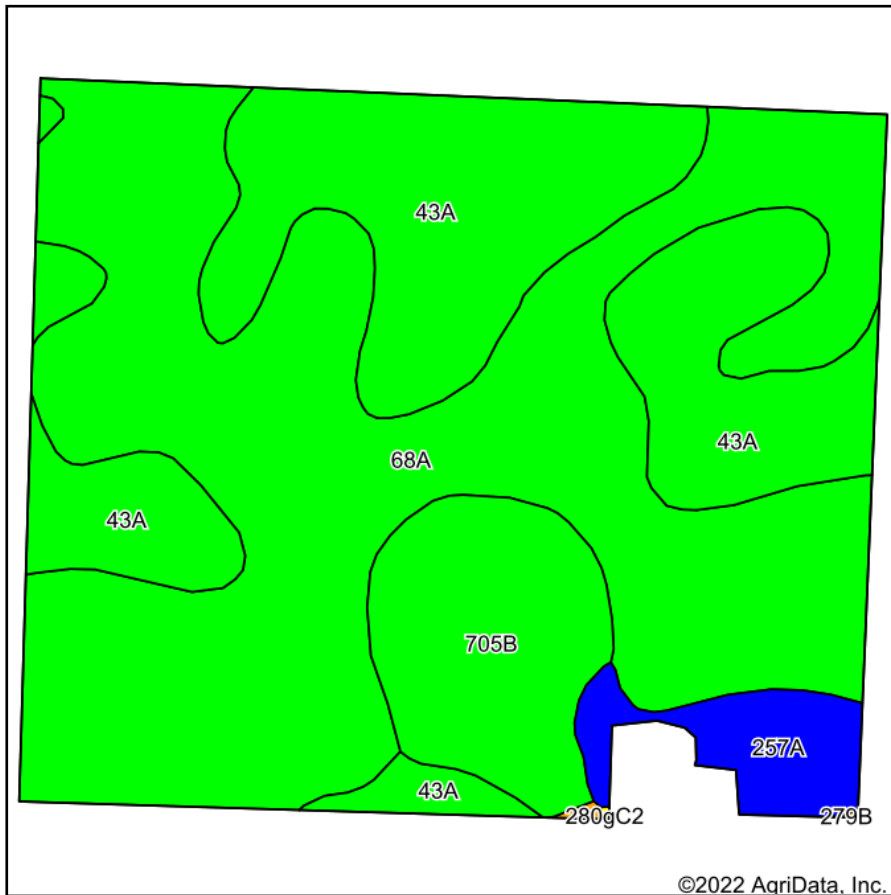

Soils data provided by USDA and NRCS.

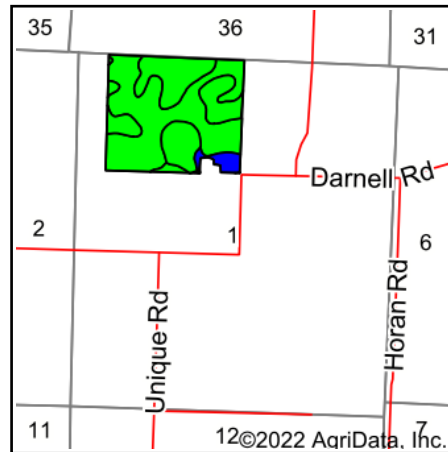

State: **Illinois**  
 County: **Sangamon**  
 Location: **1-15N-3W**  
 Township: **Cooper**  
 Acres: **98.16**  
 Date: **5/6/2022**

Maps Provided By:  
  
 CUSTOMIZED ONLINE MAPPING  
 © AgriData, Inc. 2021 [www.AgriDataInc.com](http://www.AgriDataInc.com)



Area Symbol: IL167, Soil Area Version: 14

Code	Soil Description	Acres	Percent of field	Il. State Productivity Index Legend	Subsoil rooting <sup>a</sup>	Corn Bu/A	Soybeans Bu/A	Wheat Bu/A	Oats Bu/A <sup>b</sup>	Sorghum <sup>c</sup> Bu/A	Alfalfa <sup>d</sup> hay, T/A	Grass-legume <sup>e</sup> hay, T/A	Crop productivity index for optimum management
68A	Sable silty clay loam, 0 to 2 percent slopes	54.25	55.3%		FAV	192	63	74	99	0	0.00	5.77	143
43A	Ipava silt loam, 0 to 2 percent slopes	30.14	30.7%		FAV	191	62	77	100	0	0.00	5.90	142
**705B	Buckhart silt loam, 2 to 5 percent slopes	9.79	10.0%		FAV	**188	**60	**73	**99	0	**7.33	0.00	**141
257A	Clarksdale silt loam, 0 to 2 percent slopes	3.88	4.0%		FAV	174	56	69	89	0	0.00	5.27	128
**279B	Rozetta silt loam, 2 to 5 percent slopes	0.10	0.1%		FAV	**162	**50	**64	**83	0	**5.22	0.00	**119
<b>Weighted Average</b>						<b>190.6</b>	<b>62.1</b>	<b>74.6</b>	<b>98.9</b>	<b>*</b>	<b>0.74</b>	<b>5.21</b>	<b>141.9</b>

**Table: Optimum Crop Productivity Ratings for Illinois Soil by K.R. Olson and J.M. Lang, Office of Research, ACES, University of Illinois at Champaign-Urbana.** Version: 1/2/2012 Amended Table S2 B811

Crop yields and productivity indices for optimum management (B811) are maintained at the following NRES web site: <http://soilproductivity.nres.illinois.edu/>

\*\* Indexes adjusted for slope and erosion according to Bulletin 811 Table S3

<sup>a</sup> UNF = unfavorable; FAV = favorable

<sup>b</sup> Soils in the southern region were not rated for oats and are shown with a zero "0".

<sup>c</sup> Soils in the northern region or in both regions were not rated for grain sorghum and are shown with a zero "0".

<sup>d</sup> Soils in the poorly drained group were not rated for alfalfa and are shown with a zero "0".

<sup>e</sup> Soils in the well drained group were not rated for grass-legume and are shown with a zero "0".

Soils data provided by USDA and NRCS. Soils data provided by University of Illinois at Champaign-Urbana.