

# Soils Map

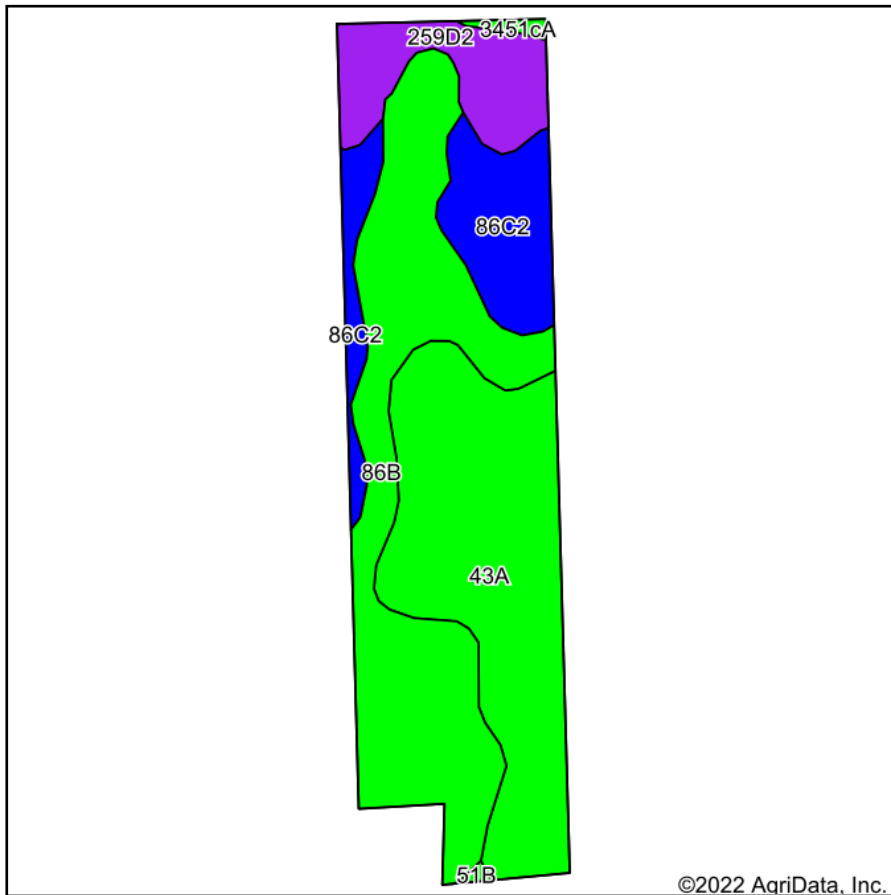

Soils data provided by USDA and NRCS.

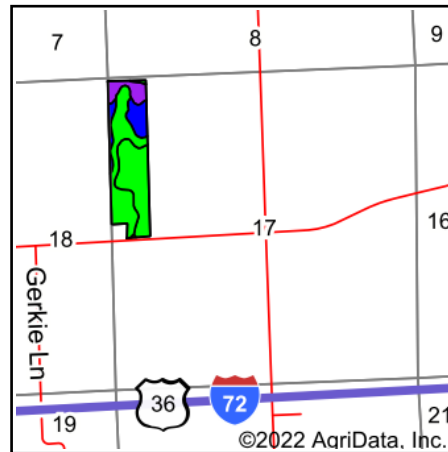

State: **Illinois**  
 County: **Morgan**  
 Location: **17-15N-9W**  
 Township: **Jacksonville No. 23**  
 Acres: **38.63**  
 Date: **1/23/2022**

Maps Provided By:



Area Symbol: IL137, Soil Area Version: 12

Code	Soil Description	Acres	Percent of field	Il. State Productivity Index Legend	Subsoil rooting <b>a</b>	Corn Bu/A	Soybeans Bu/A	Wheat Bu/A	Oats Bu/A <b>b</b>	Sorghum <b>c</b> Bu/A	Alfalfa <b>d</b> hay, T/A	Grass-legume <b>e</b> hay, T/A	Crop productivity index for optimum management
**86B	Osco silt loam, 2 to 5 percent slopes	14.60	37.8%		FAV	**189	**59	**74	**101	0	**6.83	0.00	**140
43A	Ipava silt loam, 0 to 2 percent slopes	14.14	36.6%		FAV	191	62	77	100	0	0.00	5.90	142
**86C2	Osco silt loam, 5 to 10 percent slopes, eroded	5.58	14.4%		FAV	**178	**56	**70	**95	0	**6.42	0.00	**131
**259D2	Assumption silt loam, 10 to 18 percent slopes, eroded	4.02	10.4%		FAV	**145	**46	**58	**74	0	**4.25	0.00	**106
3451cA	Lawson silt loam, cool mesic, 0 to 2 percent slopes, frequently flooded	0.21	0.5%		FAV	190	61	73	97	0	0.00	5.77	140
**51B	Muscataune silt loam, 2 to 5 percent slopes	0.08	0.2%		FAV	**198	**63	**74	**103	**137	0.00	**5.96	**146
<b>Weighted Average</b>						<b>183.6</b>	<b>58.3</b>	<b>72.8</b>	<b>96.9</b>	<b>0.3</b>	<b>3.95</b>	<b>2.20</b>	<b>135.9</b>

**Table: Optimum Crop Productivity Ratings for Illinois Soil by K.R. Olson and J.M. Lang, Office of Research, ACES, University of Illinois at Champaign-Urbana.** Version: 1/2/2012 Amended Table S2 B811

Crop yields and productivity indices for optimum management (B811) are maintained at the following NRES web site: <http://soilproductivity.nres.illinois.edu/>

\*\* Indexes adjusted for slope and erosion according to Bulletin 811 Table S3

**a** UNF = unfavorable; FAV = favorable

**b** Soils in the southern region were not rated for oats and are shown with a zero "0".

**c** Soils in the northern region or in both regions were not rated for grain sorghum and are shown with a zero "0".

**d** Soils in the poorly drained group were not rated for alfalfa and are shown with a zero "0".

**e** Soils in the well drained group were not rated for grass-legume and are shown with a zero "0".

Soils data provided by USDA and NRCS. Soils data provided by University of Illinois at Champaign-Urbana.