

Soils Map

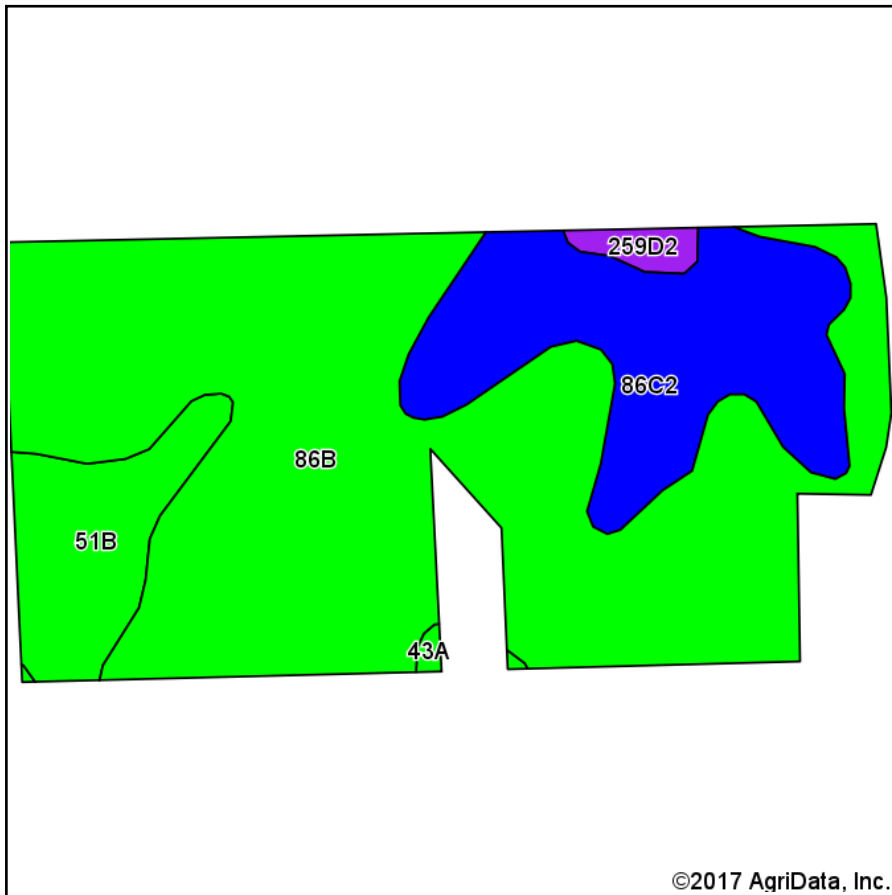

Soils data provided by USDA and NRCS.

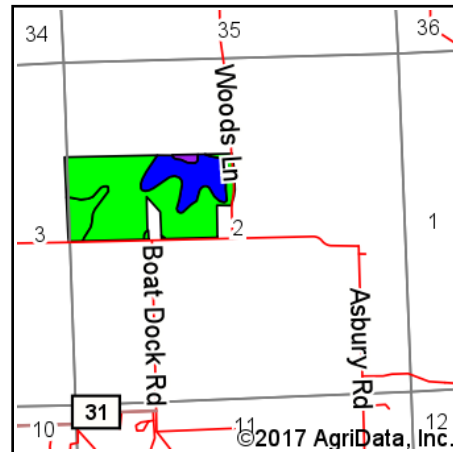

State: **Illinois**
 County: **Morgan**
 Location: **2-14N-10W**
 Township: **Jacksonville No. 24**
 Acres: **72.69**
 Date: **3/30/2017**

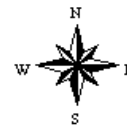

Area Symbol: IL137, Soil Area Version: 7

Code	Soil Description	Acres	Percent of field	Il. State Productivity Index Legend	Subsoil rooting ^a	Corn Bu/A	Soybeans Bu/A	Wheat Bu/A	Oats Bu/A ^b	Sorghum ^c Bu/A	Alfalfa ^d hay, T/A	Grass-legume ^e hay, T/A	Crop productivity index for optimum management
**86B	Osco silt loam, 2 to 5 percent slopes	49.71	68.4%		FAV	**189	**59	**74	**101	0	**6.83	0.00	**140
**86C2	Osco silt loam, 5 to 10 percent slopes, eroded	15.23	21.0%		FAV	**178	**56	**70	**95	0	**6.42	0.00	**131
**51B	Muscataune silt loam, 2 to 5 percent slopes	6.57	9.0%		FAV	**198	**63	**74	**103	**137	0.00	**5.96	**146
**259D2	Assumption silt loam, 10 to 18 percent slopes, eroded	0.91	1.3%		FAV	**145	**46	**58	**74	0	**4.25	0.00	**106
43A	Ipava silt loam, 0 to 2 percent slopes	0.27	0.4%		FAV	191	62	77	100	0	0.00	5.90	142
Weighted Average						187	58.6	73	99.6	12.4	6.07	0.56	138.2

Table: Optimum Crop Productivity Ratings for Illinois Soil by K.R. Olson and J.M. Lang, Office of Research, ACES, University of Illinois at Champaign-Urbana. Version: 1/2/2012 Amended Table S2 B811

Crop yields and productivity indices for optimum management (B811) are maintained at the following NRES web site:

<https://www.ideals.illinois.edu/handle/2142/1027/>

** Indexes adjusted for slope and erosion according to Bulletin 811 Table S3

^a UNF = unfavorable; FAV = favorable

^b Soils in the southern region were not rated for oats and are shown with a zero "0".

^c Soils in the northern region or in both regions were not rated for grain sorghum and are shown with a zero "0".

^d Soils in the poorly drained group were not rated for alfalfa and are shown with a zero "0".

^e Soils in the well drained group were not rated for grass-legume and are shown with a zero "0".

Soils data provided by USDA and NRCS. Soils data provided by University of Illinois at Champaign-Urbana.

*c: Using Capabilities Class Dominant Condition Aggregation Method